

#	Revision	Date

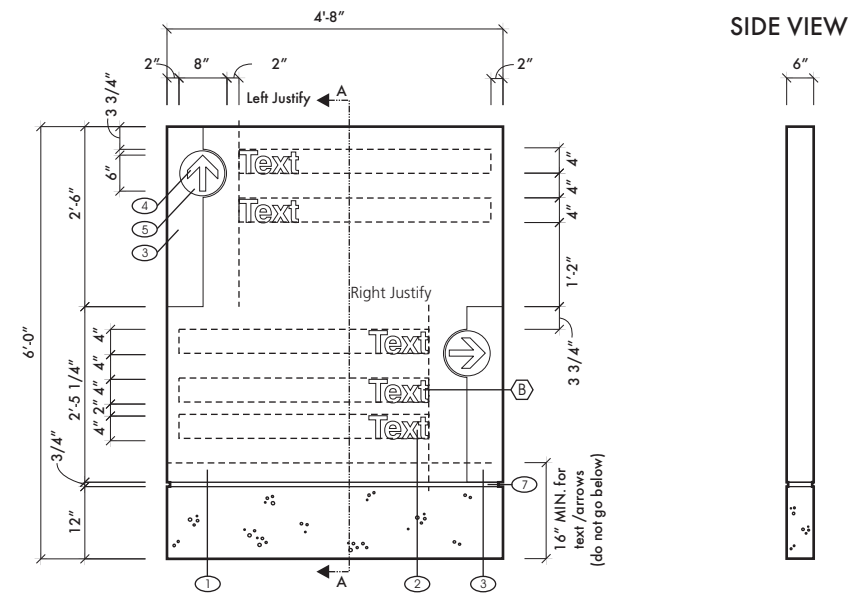

SIDE VIEW

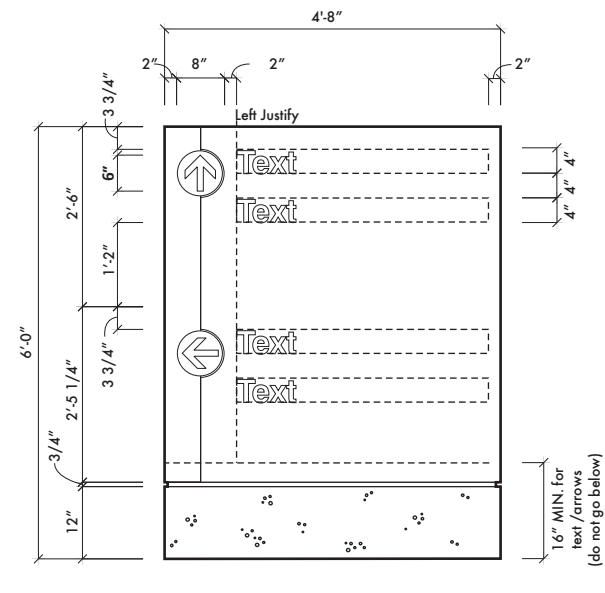

SIGN FACE ALTERNATE LAYOUT

Scale: 3/8"=1'-0"

SIGN FACE LAYOUT

Scale: 3/8"=1'-0"

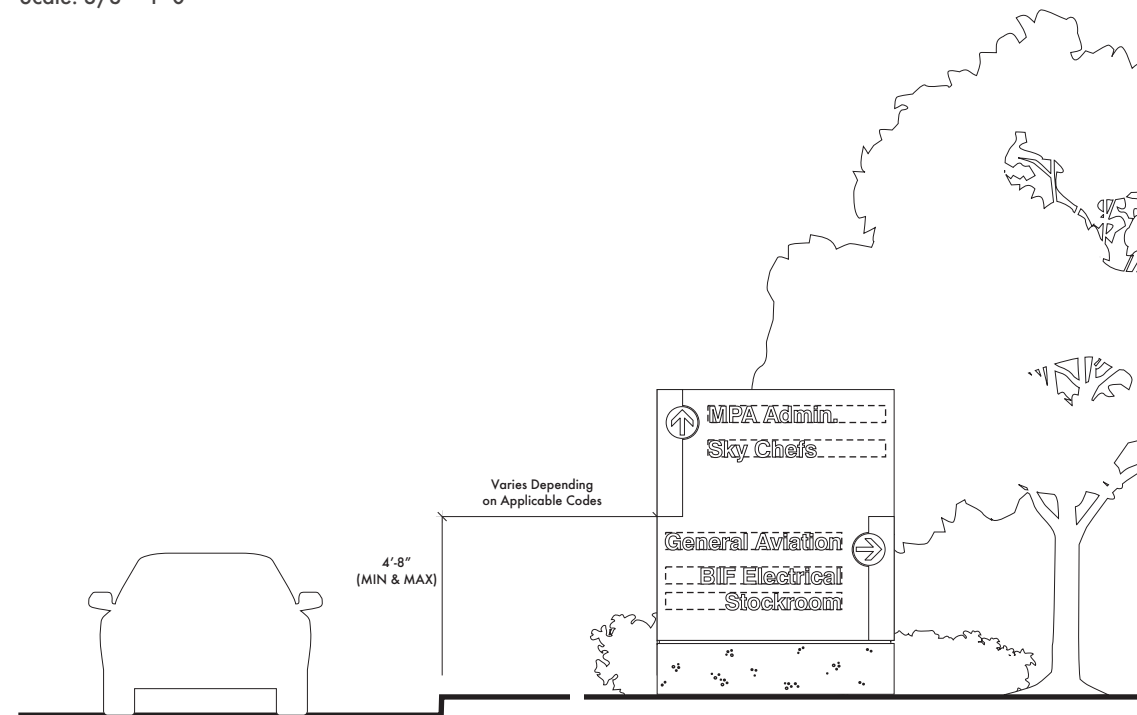

ELEVATION

Scale: N. T. S.

DETAIL A - A (For Design Intent Only)

Scale: N. T. S.

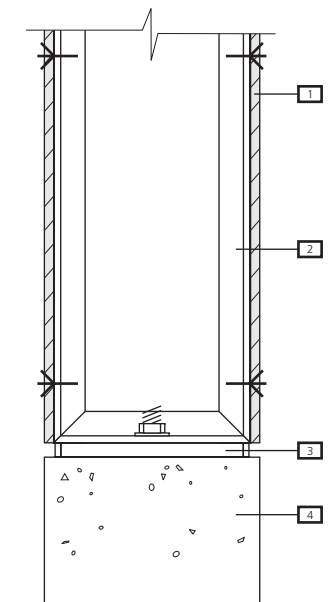

Freestanding

ST - 501

DESCRIPTION: Vehicular Roadside-Directional.

LOCATION: Roadside perpendicular to vehicular traffic.

MATERIALS: Aluminum sign face structure with cast in place concrete footer.

LETTERING:  
 A Swiss721 Black BT  
 B Swiss721 BT Bold

SYMBOLGY: N/A

COLORS:  
 1 Background: Paint Black Matthew's Paint #78A-1A or approved equal (Jet Black)  
 2 Text: 3M Diamond Grade Film #3990 or approved equal (White)  
 3 Band: Paint to match PMS425C (Grey)  
 4 Arrow: 3M Diamond Grade Film #3990 or approved equal (White)  
 5 Arrow Circle: Paint Black Matthew's Paint #78A-1A or approved equal (Jet Black)  
 6 Header Panel: Paint Matthew's Paint #41-342 Brushed Aluminum  
 7 Reveal: Paint to match PMS425C (Grey)

GRAPHICS: N/A

ARROWS: 8" (Refer to Section 2.4.1)

MOUNTING: Freestanding

ILLUMINATION: Sign will be non illuminated.

NOTES:

- 1 .060 (1/8") aluminum sign face and side returns with machine cut top edge as shown. Paint sign faces and side returns first surface, matte finish. Message copy and arrows to be 3M Reflective film applied first surface (see color specification above). Mechanically attach to channel frame structure with countersunk screws, paint to match face
- 2 Aluminum channel frame cabinet. Mechanically attach to concrete base with appropriately sized cast-in-place thru-bolts (must be breakaway capable).
- 3 Break-formed two piece aluminum spacer reveal.
- 4 Cast-in-place concrete footer.

Directional - Primary

3.6.1

